

## Idle-Lock™ B-IDLE556

### Idle Anti-Theft

### 2020 - 2021 Ford Interceptor Utility

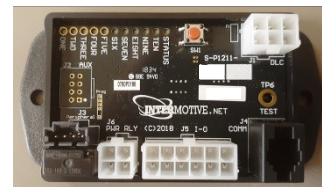

## Introduction

Idle-Lock is an anti-theft system that allows the engine to idle with the key removed from the ignition and the shifter locked in park. The system is activated by pressing a momentary enable switch and removing the key within three seconds. Idle-Lock will automatically shut off the engine if anyone attempts to steal the vehicle by shifting out of Park while the key is removed (shifter remains locked in Park). Idle-Lock is instantly disabled when the key is inserted and turned to Run.

## Installation Instructions

**Disconnect vehicle battery before proceeding with installation**



**WARNING**  
Disconnect the battery to prevent setting a check engine light.

## CAUTION

All electronic products are susceptible to damage from Electrostatic Discharge or ESD. Ground yourself before handling or working with the module and harnessing by first touching chassis ground, such as the barrel of the cigarette lighter.



It is the installer's responsibility to route and secure all wiring harnesses where they cannot be damaged by sharp objects, mechanical moving parts and high heat sources. Failure to do so could result in damage to the system or vehicle and create possible safety concerns for the operator and passengers.

It is important to avoid placing the module where it could encounter strong magnetic fields from high current cabling connected to motors, solenoids, etc. Also avoid radio frequency energy from antenna's or inverters next to the module. Finally, avoid high voltage spikes in vehicle wiring by always using diode clamped relays when installing upfitter circuits.

## IDLE556 Module

Locate the module in an area away from any external heat sources (engine heat, heater ducts, etc.). Ensure when routing harnesses that the tilt steering column does not contact them in the full down position. When installing the harnesses, leave several inches of take-out such that the module can be removed if necessary.

## Installation Instructions (continued)

### Gateway Plug and Play Harness (6-pin connector)

1. Locate the vehicles Gateway Module (C2431). It will be mounted below the lower left dash panel behind the BCM.
2. Remove the harness behind the Gateway module by pressing the locking tab and pulling outward.
3. Plug the Female side of the InterMotive Gateway Harness into the back of the Gateway module. Ensure the connection is fully seated and secured by the locking tab.
4. Plug the Male side of the InterMotive Data Link Harness into the Gateway harness.
5. Secure the IDLE556 Gateway harness so that it does not hang below the lower dash panel.

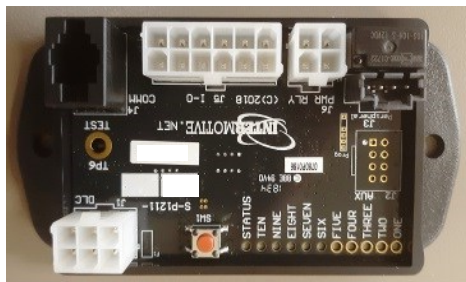

Data Link Harness  
plugs in here

Gateway Module

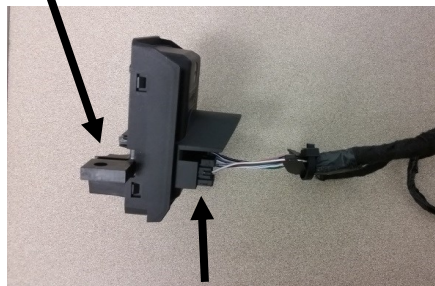

Gateway Harness



InterMotive Plug and Play Gateway Harness

## Installation Instructions (continued)

### I/O Wiring, Features, and Descriptions: (Solder and heat shrink all connections)

#### Shift Lock Harness Installation

##### Sedan and Utility

1. Locate the OEM shift lock solenoid at the side of the steering column (photo below).
2. Remove the OEM 4-pin Black connector from the shift lock solenoid assembly.
3. Idle Lock provides a shift lock T-harness. Plug one leg of the Idle Lock T-harness into the OEM shift lock solenoid, and the other leg into the OEM harness.
4. Route the third leg of the Idle Lock T-harness to the Idle Lock module on the left side of the dash. Plug the White 4 pin connector into the mating connector on the Idle Lock module.

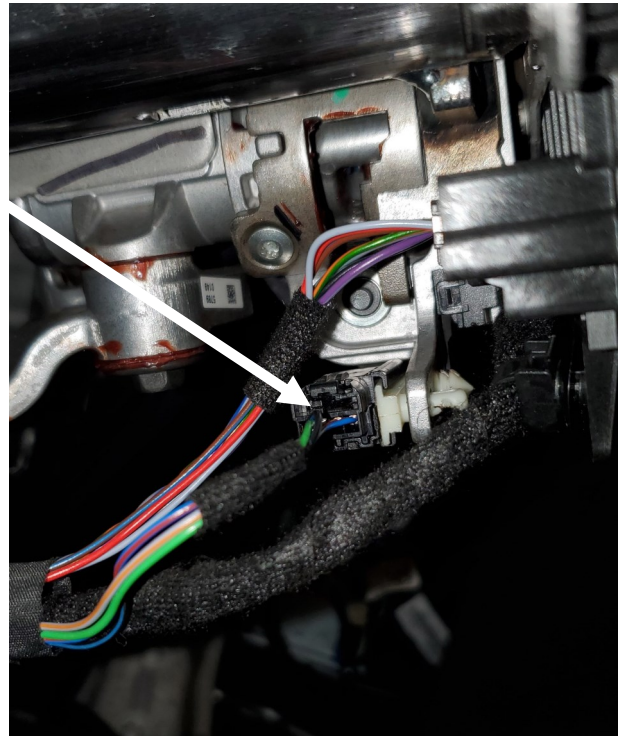

#### Lock Output

Pin 2, White wire of the 12 pin connector is the Idle-Lock output. This output (500mA max current) can control installer supplied normally closed relays to disable the trunk and weapon rack release buttons when Idle-Lock is active. When Idle-Lock activates this output, the relays will open the circuits from the buttons and disable them. This minimizes possible theft when Idle-Lock is active and the vehicle is unattended.

When Idle-Lock is enabled, this output becomes active after a 10 second delay. This output remains active until the key is back in the run position.

#### Idle-Lock Enable Switch and Active LED

An LED is provided in the kit which lights when Idle-Lock is active.

1. Drill a 16mm (0.630") hole in the desired mounting location. One possibility is the dash panel to the left of the Steering Wheel.
2. Route the LED harness through the hole and mount the LED in the hole.
3. Slide the LED's lock nut onto the harness and snug it down onto the back of the LED.
4. Plug in the 4 pin (Black) connector of the LED harness into the mating connector on the Idle-Lock main harness.
5. Apply optional "Idle-Lock Enable/Active" label included in the kit.





## Installation Instructions (continued)

### Ignition Switch Harness

The ignition switch must be accessed in order to connect the Idle-Lock ignition harness. Several dash trim panels must be removed.

- Using a non-marring pry tool, remove the lower finish panel from the center stack on the dash.
- Using a non-marring pry tool, remove the upper finish panel from the center stack on the dash.
- Locate the ignition switch connector and disconnect it from the ignition switch.
- Plug the OEM switch harness connector into the female connector of the Idle-Lock Ignition Switch harness.
- Connect the male Idle-Lock Ignition switch harness connector to the OEM ignition switch.



## **IDLE556 Module Mounting**

Ensure all harnesses are properly connected and routed, and are not hanging below the dash area. Mount the module as described on page one and secure with supplied screws or double sided tape.

## **IDLE556 Harness (4 Pin connector and 12 Pin connector)**

1. Plug the IDLE556 12 Pin connector into the mating 12 pin connector on the IDLE556 module.
2. Plug the IDLE556 4 Pin connector into the mating 4 pin connector on the IDLE556 module.

## **Reconnect the vehicle battery**

## **Post Installation Operational Test**

**Test 1.** Start the Engine.

**Test 2.** While the engine is running, enable Idle-Lock by momentarily pressing the red enable switch.

- The Red LED will flash five times and then blink every two seconds.
- Remove the key from the ignition within 3 seconds, the engine will continue to idle.
- Idle-Lock is now active.

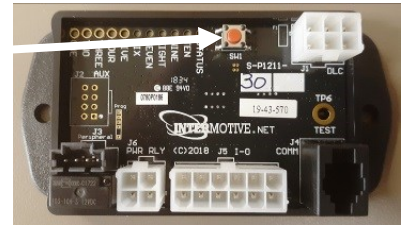

**Test 3.** If the Lock Output is wired to disable the trunk and/or weapon rack release, verify this occurs 10 seconds after removing the key in Idle-Lock mode.

**Test 4.** Attempt to shift the vehicle out of Park. The system will shut down the engine and keep the shifter locked.

**Test 5.** Insert key into the ignition and start the vehicle. Verify the shifter is not locked.

**If the system fails any of the above tests, check the related wiring. If necessary, call InterMotive Technical Support at 530-823-1048. Do NOT release vehicle for service unless it has passed ALL of the above tests.**

**Leave in Vehicle  
Operating Instructions  
Idle-Lock™ B-IDLE556  
2020 - 2021 Ford Interceptor Utility**



Idle-Lock is an anti-theft system that allows the engine to idle with the key removed from the ignition and the shifter locked in park. The system is activated by pressing a momentary enable switch and removing the key within three seconds. Idle-Lock will automatically shut off the engine if anyone attempts to steal the vehicle by shifting out of Park while the key is removed (shifter remains locked in Park). Idle-Lock is instantly disabled when the key is inserted and turned to Run.

- Idle-Lock is enabled by removing the key from the ignition within 3 seconds of pressing the red enable switch. Transmission must be in Park.
- To prevent unattended vehicle theft (Idle-Lock active), the engine will turn off if someone attempts to shift the vehicle out of Park. The shifter will remain locked, and the trunk and weapons rack release buttons will remain disabled.
- Inserting the key and turning it to Run restores normal operation. The trunk and weapons rack release buttons are restored to normal operation.

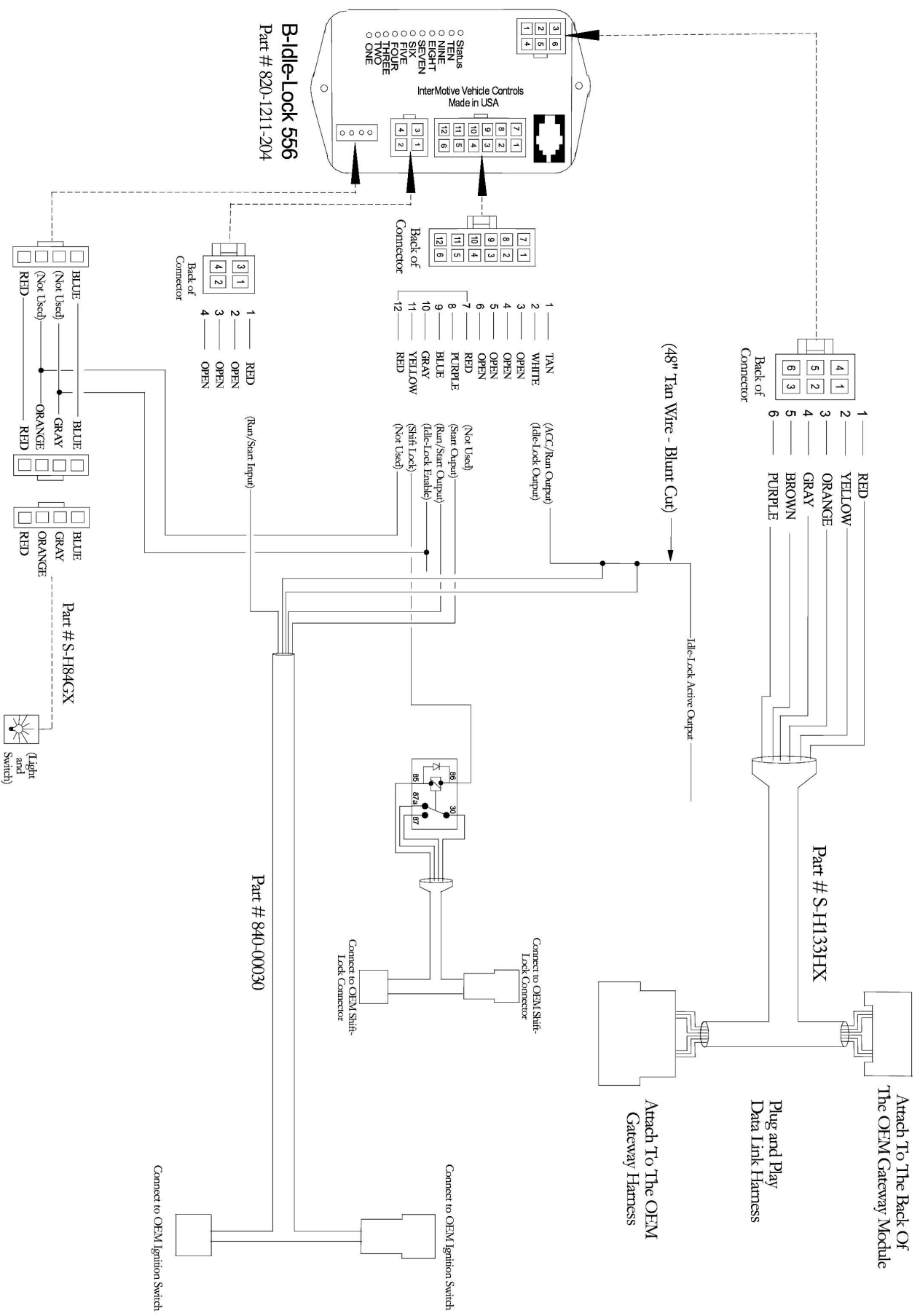

**Submit product registration at [www.intermotive.net](http://www.intermotive.net)**

If the Idle-Lock 556 fails any step in the Post Installation Test, review the installation instructions and check all connections.

If necessary, call InterMotive Technical Support at (530) 823-1048.